

PCB ADAPTER

PCB ADAPTER 2.5

Order Number:

891-700-007 (Set of 10)

891-700-008 (Set of 25)

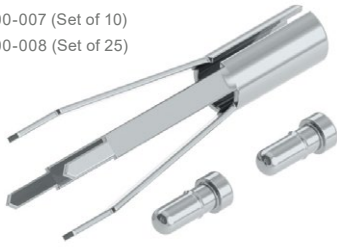

Materials: Spring steel, Nickel-plated

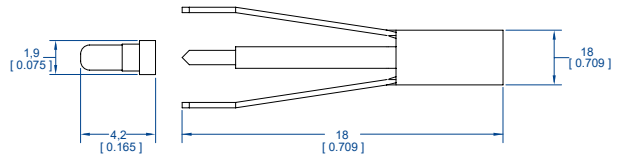

*) Units in millimeters [inch]

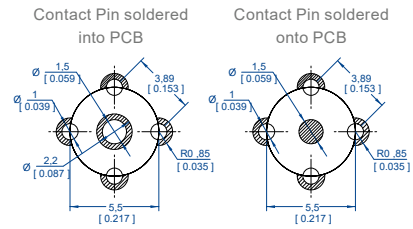

PCB ADAPTER 2.5 HQ

Order Number:

890-700-017

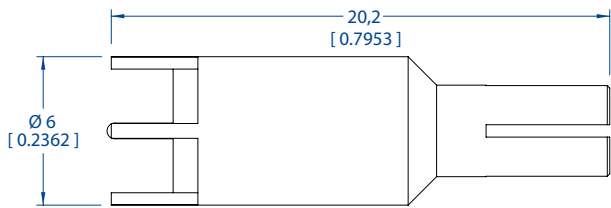

*) Units in millimeters [inch]

This Accessory is useable with spring-loaded probe tips only.

Materials: Shell: Brass alloy, nickel-plated
Socket: Brass alloy, gold-plated
Insulator: PTFE

Rating Accessories

PCB Adapter 2.5 HQ / PCB Adapter 2.5 90° HQ

Maximum Rated Input Voltages, No Measurement Category, not in CAT II, III, IV (1)

Pollution Degree: 2

No Measurement Category: 250 V, 1600 V peak

Maximum Pulse Rating, No Measurement Category, not in CAT II, III, IV (1)

Upulse (2) = 1600 V (Step 0 V to 1600 V)



Drilling / soldering template

The minimum distance between all solder pads of 1.25 mm (see adjacent template) must not be undercut under any circumstances. Undercutting this distance will void the rating.

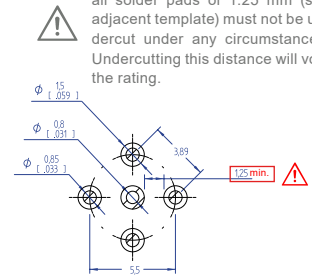

PCB ADAPTER 2.5-90°

Order Number:

890-700-027

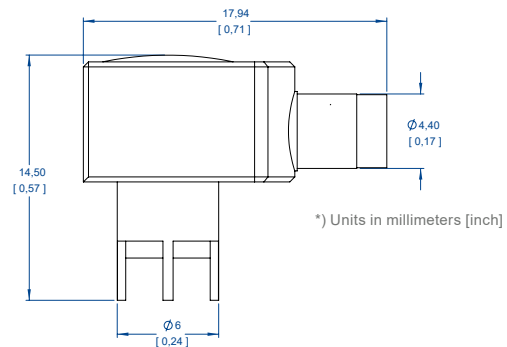

*) Units in millimeters [inch]

This Accessory is useable with spring-loaded probe tips only.

Materials: Shell: Brass alloy, nickel-plated
Socket: Brass alloy, gold-plated
Insulator: PTFE

Rating Accessories

PCB Adapter 2.5 HQ / PCB Adapter 2.5 90° HQ

Maximum Rated Input Voltages, No Measurement Category, not in CAT II, III, IV (1)

Pollution Degree: 2

No Measurement Category: 250 V, 1600 V peak

Maximum Pulse Rating, No Measurement Category, not in CAT II, III, IV (1)

Upulse (2) = 1600 V (Step 0 V to 1600 V)

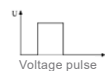

Drilling / soldering template

The minimum distance between all solder pads of 1.25 mm (see adjacent template) must not be undercut under any circumstances. Undercutting this distance will void the rating.

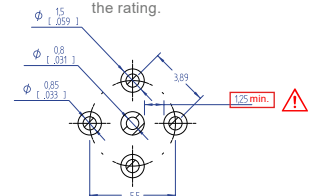

(1) As defined in IEC 61010-031. (2) No overshoot permitted.

PCB ADAPTER 5.0

Order Number:
890-700-000



Materials: Shell: Brass alloy, nickel-plated
Socket: Brass alloy, gold-plated
Insulator: PTFE

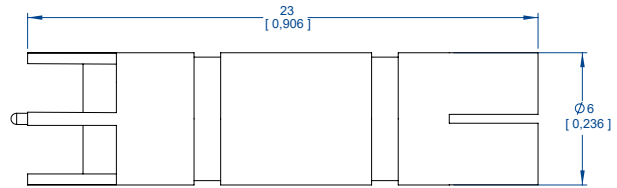

Rating Accessories

*) Units in millimeters [inch]

PCB Adapter 5.0

Maximum Rated Input Voltages, No Measurement Category, not in CAT II, III, IV (1)

Pollution Degree: 2
No Measurement Category: 250 V, 1600 V peak

Maximum Pulse Rating, No Measurement Category, not in CAT II, III, IV (1)

Upulse (2) = 1600 V (Step 0 V to 1600 V)



Drilling / soldering template

The minimum distance between all solder pads of 1.25 mm (see adjacent template) must not be undercut under any circumstances. Undercutting this distance will void the rating.

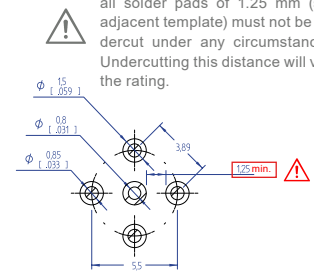

PCB ADAPTER 5.0 L

Order Number:
890-700-006



Materials: Shell: Brass alloy, nickel-plated
Socket: Brass alloy, gold-plated
Insulator: PTFE

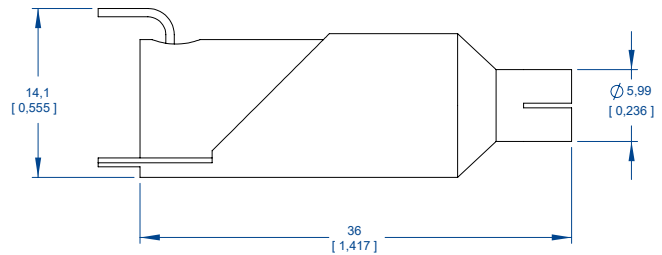

*) Units in millimeters [inch]

Rating Accessories

PCB Adapter 5,0-L

Maximum Rated Input Voltages, No Measurement Category, not in CAT II, III, IV (1)

Pollution Degree: 2
No Measurement Category: 2000 V, 6000 V peak

Maximum Pulse Rating, No Measurement Category, not in CAT II, III, IV (1)

Upulse (2) = 6000 V (Step 0 V to 6000 V)



Drilling / Soldering Template

The minimum distance between all solder pads of 11.4 mm (see adjacent template) must not be undercut under any circumstances. Undercutting this distance will void the rating.

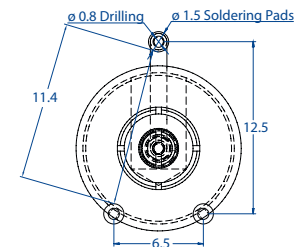

Deutschlands größter B2B-Onlineshop für Mess- und Prüftechnik.



Mess- und Prüftechnik, Die Experten.

Ihre Vorteile:

- > Eine unschlagbare Auswahl namhafter Hersteller
- > Hohe Lagerkapazität und kurze Wege
- > Bundesweite Lieferung und schnelle Zustellung meist innerhalb eines Tages
- > Mehrere tausend Mess- und Prüfgeräte
- > Tagesaktuelle Preise und Promotions
- > Warenkorbrabatt bei Online-Bestellung
- > Versandkostenfrei ab € 50,-
- > Dokumenten-Download u. v. m.

